

Bidbury & Co.

HOW TO REFIT THE
CHARLBURY HANDLE



INSTALLATION INSTRUCTIONS

INSTRUCTIONS



PLEASE READ THESE INSTRUCTIONS CAREFULLY AND KEEP IN A SAFE PLACE FOR FUTURE REFERENCE.

This will require two people to complete

ENSURE COLD SUPPLY IS TURNED OFF BEFORE REMOVING ANY PARTS.



1 Isolate water supply before starting.



2 Unscrew and remove the spray cover and rubber seal.



3 Remove inner brass ring.



4 Take care to keep upright to ensure inner fitting do not fall out.

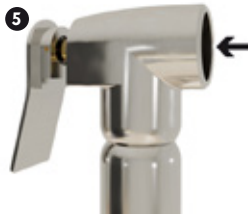

5 Using the end of a wooden spoon or similar, push the inner mechanism towards the lever.



6 The pin and lever can be removed to reveal the internal shaft.



7 Whilst holding in position, line up the lever and place the pin through both holes.



8 Release the internal mechanism to return back to original position.



9 Re-fit all other parts in reverse order. **NOTE:** do not over tighten the spray cover – doing this will take pressure off the pin and cause it to fall out.

For further assistance, please contact Bidbury & Co Customer Support at www.bidburyandco.com or 0333 33 55 956